



# Warringah Freeway Upgrade Work

## Alfred Street southbound off ramp, North Sydney closed from 10pm Friday 22 November 2024 to mid-2025

### Key

- Closure Alfred Street southbound off ramp, North Sydney
- Alternative route to North Sydney and Kirribilli from Pacific Highway
- Alternative route via Reserve Road
- Alternative route via Willoughby Road
- Alternative route via Brook Street
- Alternative route via Miller Street
- Mount Street on ramps open
- Detour route for closure on Alfred Street North between Kurraba Road and Mount Street
- Toll applies

Use Pacific Highway exit if coming from Lane Cove Tunnel, Epping Road or Longueville Road

Motorists should use Pacific Highway from Reserve Road, Willoughby Road, Brook Street and Miller Street when accessing North Sydney, Kirribilli and Neutral Bay to avoid paying a TOLL via the freeway.

Temporary long-term closure of the Alfred Street off ramp, North Sydney

Alfred Street North closed from Kurraba Road to Mount Street

Mount Street to Alfred Street North closed

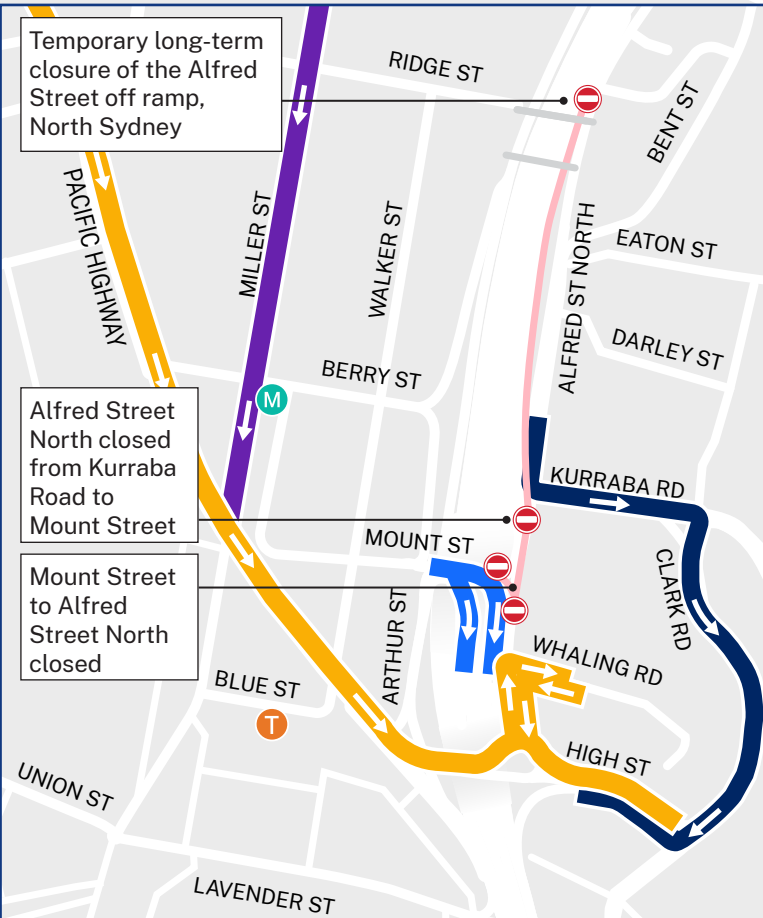

Subject to change. Visit [livetraffic.com](http://livetraffic.com) for more details. Visit [transportnsw.info](http://transportnsw.info) to plan your trip.